

# Immediate Occupancy

374 Stavanger Drive / Lot 1

3,104 sq.ft. (incl. basement)

(garage sq.ft - 311 sq.ft)



## \$419,900\*

This large bungalow with great curb appeal comes with an attached garage and backs on to greenspace to provide a little extra privacy. Inside you have gleaming hardwood floors and ceramic tiles to go along with a stunning white kitchen. The basement is partially developed with a recroom and full bathroom. Recently installed "horseshoe" driveway allows you to enter and exit the driveway with ease and avoid backing into traffic.



MLS®: 1162755

### Standard Finishes:

9' ceilings on main | Hardwood in living, dining, halls & kitchen | Hardwood staircase | Ceramic tile in entry, baths & powder  
Crown throughout main floor living areas | 5" wide baseboards | 2 3/4" wide door & window casings | Laminate in basement family  
Tiled backsplash in kitchen

### This Home Features:

3 Bedrooms / 3 Baths | Attached garage | Open concept kitchen, dining & living | Breakfast nook | Main floor laundry  
Master bedroom with large walk-in closet and luxury ensuite with stand alone soaker tub, stand up shower & double sinks in the vanity  
Finished family room & full bath in basement | Oversized lot | 7 year Atlantic Home Warranty | Fully landscaped and paved driveway



Built by: **HORIZON**  
HOMES

(709) 738-2995 | (709) 738-7587 (PLUS) | [info@clovellytrails.com](mailto:info@clovellytrails.com) | [www.clovellytrails.com](http://www.clovellytrails.com)



\* All illustrations are artist's concepts. Homes may be left or right versions. Above floor plans apply to elevations of this model type only, all dimensions are approximate. Actual usable floor space may vary from stated floor area. Structural/mechanical requirements may result in dimensional revisions. Plans and specifications are subject to change without notice. Exterior elevations are determined by the vendor's architect and may vary. Some exterior finishes shown are upgrade options. Home designs are subject to lots specifications. E. & O. E. 11/29/17

# Floor Plan

374 Stavanger Drive / Lot 1

3,104 sq.ft. (incl. basement)

(garage sq.ft - 311 sq.ft)



[www.clovellytrails.com](http://www.clovellytrails.com)



Main Floor 1,552 sq.ft.

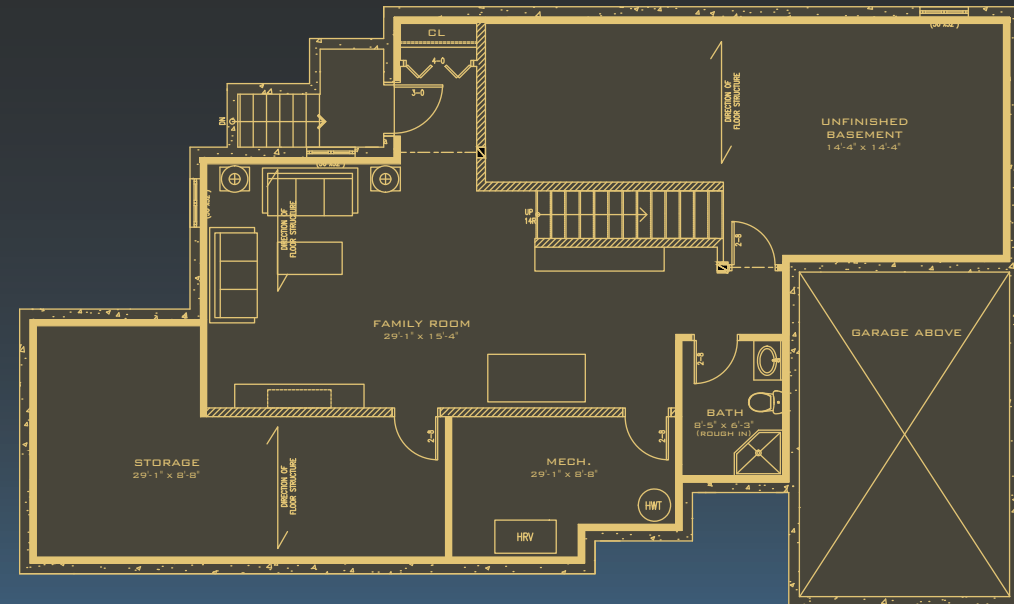

Basement 1,552 sq.ft.

\* All illustrations are artist's concepts. Homes may be left or right versions. Above floor plans apply to elevations of this model type only, all dimensions are approximate. Actual usable floor space may vary from stated floor area. Structural/mechanical requirements may result in dimensional revisions. Plans and specifications are subject to change without notice. Exterior elevations are determined by the vendor's architect and may vary. Some exterior finishes shown are upgrade options. Home designs are subject to lots specifications. E. & O. E. 11/29/17